



GPL series GPL 121000



Valve Regulated Lead Acid Battery

Maintenance-Free Sealed Lead Acid Battery.
Absorbent Glass Mat (AGM) technology for efficient gas recombination of up to 99%.

General Design for Standby Power Applications

【Design Life】

Up to 10 Years in Standby Service at 25°C
Eurobat (20°C) : >12 YEARS VERY LONG LIFE

【Operating Temperature Range】

Nominal Operating Temperature : 25°C (77°F)
Discharge : -15°C ~ 50°C (5°F~122°F)
Charge: -15°C ~ 40°C (5°F~104°F)
Storage: -15°C ~ 40°C (5°F~104°F)

【Float Charging Voltage】

13.5 ~ 13.8 VDC/Unit at 25°C (77°F)

【Equalization Charging Voltage】

14.4 ~ 15.0 VDC/Unit at 25°C (77°F)

【Self Discharge】

Less than 10% after 90 days, can be stored up to 6 months at 25°C (77°F);
Fully recharging is required before usage, and charged sooner if stored at higher temperature than 25°C (77°F).

Specification Design according with IEC 60896-21/22:2004

Nominal Voltage	12V (6 cells per unit)	
Nominal Capacity	100 Ah @20hr-rate to 1.75V per cell @25°C (77°F)	
Weight	Approx. 33.50 Kg (73.83 lbs)	
Maximum Discharge Current	800A (5sec)	
Internal Resistance	Approx. 3.2mΩ	
Short Circuit Current	2606A	
Maximum Charge Current	30.00A	
Terminal types	I2 thread lead alloy terminal to accept M6 bolt	
Terminal tightening torque	51.7±10.3 Kgf·cm / 44.9±9.0 Lbf·in / 5.10±1.0 N·m	
Container Material	PP (UL 94-HB) & Flame Retardant (94-V0) available upon request	
Dimensions	Length (L)	343.0±2.5 mm 13.50±0.10 inch
	Width (W)	170.0±2.0 mm 6.69±0.08 inch
	Container Height (h)	213.9±2.5 mm 8.42±0.10 inch
	Overall Height (H)	216.9±2.5 mm 8.54±0.10 inch

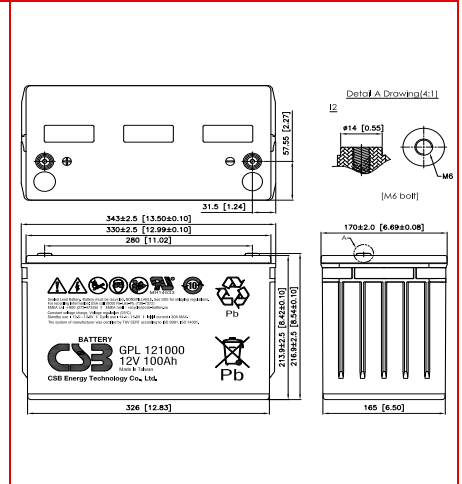

Constant Current Discharge Characteristics Unit: A (25°C, 77°F)

F.V/Time	5MIN	10MIN	15MIN	30MIN	60MIN	90MIN	2HR	3HR	5HR	8HR	10HR	20HR
1.60V	423	277	212	127	73.0	52.1	41.1	29.1	18.9	12.2	10.00	5.27
1.67V	375	266	207	125	72.4	51.7	40.7	29.0	18.8	12.1	9.93	5.22
1.70V	355	258	203	124	71.8	51.4	40.6	28.7	18.6	12.0	9.88	5.20
1.75V	317	240	194	120	71.1	50.9	40.2	28.6	18.5	11.9	9.81	5.19
1.80V	283	219	183	115	68.9	49.6	39.3	27.9	18.2	11.8	9.66	5.09
1.85V	245	196	164	106	65.2	47.2	37.6	26.8	17.4	11.4	9.45	4.92

Constant Power Discharge Characteristics Unit: W (25°C, 77°F)

F.V/Time	5MIN	10MIN	15MIN	30MIN	60MIN	90MIN	2HR	3HR	5HR	8HR	10HR	20HR
1.60V	4159	2950	2331	1436	849	610	482	342	223	153	125	63.5
1.67V	4008	2837	2273	1417	843	607	480	340	222	152	124	63.3
1.70V	3863	2772	2252	1404	840	604	478	339	221	151	123	63.2
1.75V	3572	2623	2181	1372	830	599	475	337	220	150	122	62.4
1.80V	3184	2442	2049	1316	809	585	465	331	217	148	121	61.4
1.85V	2769	2227	1856	1234	767	557	444	320	210	142	117	60.0

Please refer to the official site for the latest rating confirmation. URL: www.csb-battery.com

Issued: 200914

Sales Offices

希世比能源科技股份有限公司
CSB Energy Technology Co., Ltd.

BUSINESS HEADQUARTERS

Tel: +886-2-2880-5600
Fax: +886-2-2888-3300

USA OFFICE

Tel: +1-817-244-7777 / 1-(800)3-CSB-USA (272872)
Fax: +1-817-244-4445

SHENZHEN OFFICE (CHINA)

Tel: +86-755-8831-6488/6775/6075
Fax: +86-755-8831-6548

EUROPE (EMEA) OFFICE

Tel: +31(0)180-418-140
Fax: +31(0)180-418-327

SHANGHAI OFFICE (CHINA)

Tel: +86-21-5046-1622/0833/0094
Fax: +86-21-5046-1046

Recognized under UL 1989,
and certified by ISO 9001, 14001, 45001, 50001.



TAIPEI OFFICE

Tel: +886-2-2880-5600
Fax: +886-2-2888-3300

BEIJING OFFICE (CHINA)

Tel: +86-10-6597-8065/8165/8265
Fax: +86-10-6597-8565